

Manual

LOGO 600

Mikado
Model Helicopters
www.mikado-heli.de



Manual Mikado LOGO 600

Safety Instructions. 2

Tools for Assembly & R/C Equipment 2

1 Mainframe 3

2 Tail Rotor. 4

3 Tail Boom 5

4 Main Gear & Tail Boom Assembly 6

5 V-Bar Rotor Head 7

6 Servo Installation 8

7 Mounting the Motor 9

8 Canopy Mounting 9

9 Radio and Battery 10

10 Overview Chassis 11

11 Overview Tail Rotor. 12

12 Overview V-Bar Head 13

Max. rotorhead rpm LOGO 600: 2000

Max. collective range: +/- 12°

Max. Rotor blade size: 600 mm - 620 mm

Max. LiPo Akku size: 10S 5000 mAh

LOGO 600 is not recommended for novices. This helicopter is a complex system. Basic knowledge of the function of a model helicopter is required to build and operate the LOGO 600.

Note: There is no bag 4 and 10. The bags are numbered 1 to 12, with the exception of 4 and 10.

Safety Instructions

OPERATING YOUR MODEL SAFELY

Operate the helicopter in spacious areas with no people nearby.

!Warning: Do NOT operate the helicopter in the following places and situations (or else you risk severe accidents):

- in places where children gather or people pass through
- in residential areas and parks
- indoors and in limited space
- in windy weather or when there is any rain, snow, fog or other precipitation

If you do not observe these instructions you may be held reliable for personal injury or property damage!

Always check the R/C system prior to operating your helicopter. When the R/C system batteries get weaker, the operational range of the R/C system decreases. Note that you may lose control of your model when operating it under such conditions.

Keep in mind that other people around you might also be operating a R/C model.

Never use a frequency which someone else is using at the same time. Radio signals will be mixed and you will lose control of your model.

If the model shows irregular behavior, bring the model to a halt immediately. Turn off all power switches and disconnect the batteries. Investigate the reason and fix

the problem. Do not operate the model again as long as the problem is not solved, as this may lead to further trouble and unforeseen accidents.

!Warning: In order to prevent accidents and personal injury, be sure to observe the following:

Before flying the helicopter, ensure that all screws are tightened. A single loose screw may cause a major accident.

Replace all broken or defective parts with new ones, as damaged parts lead to crashes.

Never approach a spinning rotor. Keep at least 10 meters/yards away from a spinning rotor blades.

Do not touch the motor immediately after use. It may be hot enough to cause burns.

Perform all necessary maintenance.

PRIOR TO ADJUSTING AND OPERATING YOUR MODEL, OBSERVE THE FOLLOWING

!Warning: Operate the helicopter only outdoors and out of people's reach as the main rotor operates at high rpm!

! Warning: While adjusting, stand at least 10 meters/yards away from the helicopter!

Novice R/C helicopter pilots should always seek advice from experienced pilots to obtain hints with assembly and for pre-flight adjustments. Note that a badly assembled or insufficiently adjusted helicopter is a safety hazard!

In the beginning, novice R/C helicopter pilots should always be assisted by an experienced pilot and never fly alone!

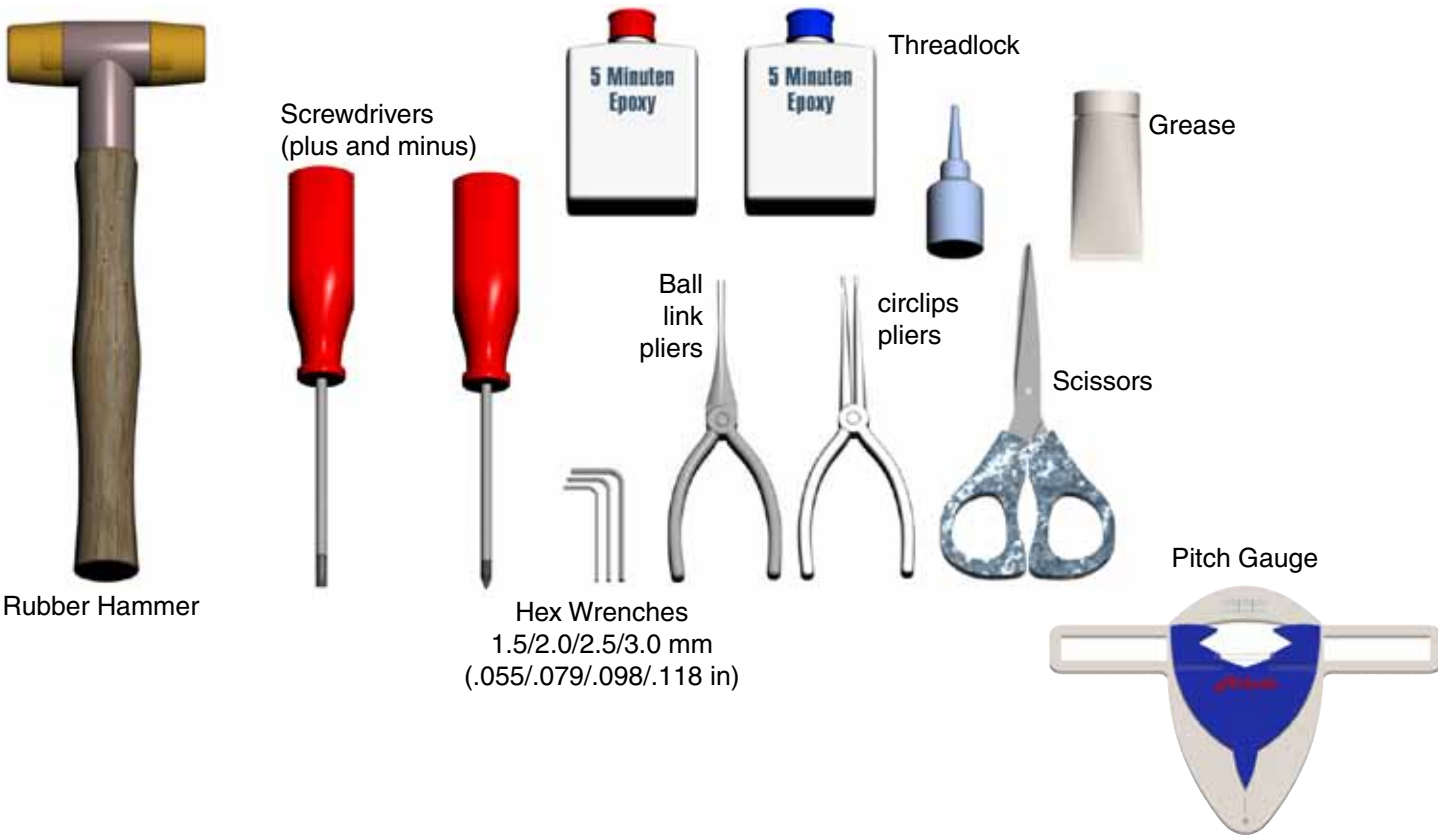

Alle shown products are examples. You may use different brands.



1 Mainframe

Bag 1

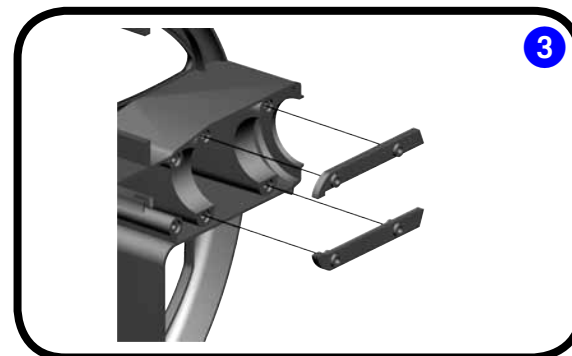
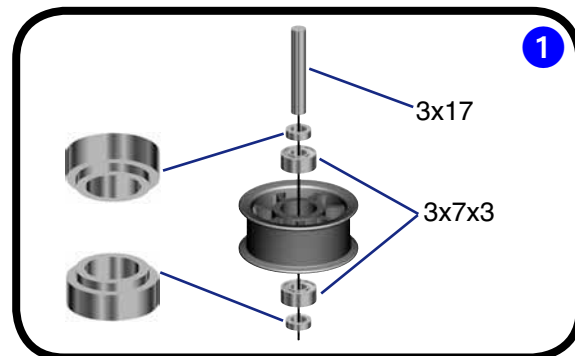

Before you combine the two sides of the main frame, attach the two belt tensioners (#4089, bag 6).

Using the rod M2.5x60 from bag 7, position all 14 nylon nuts in the right side frame.

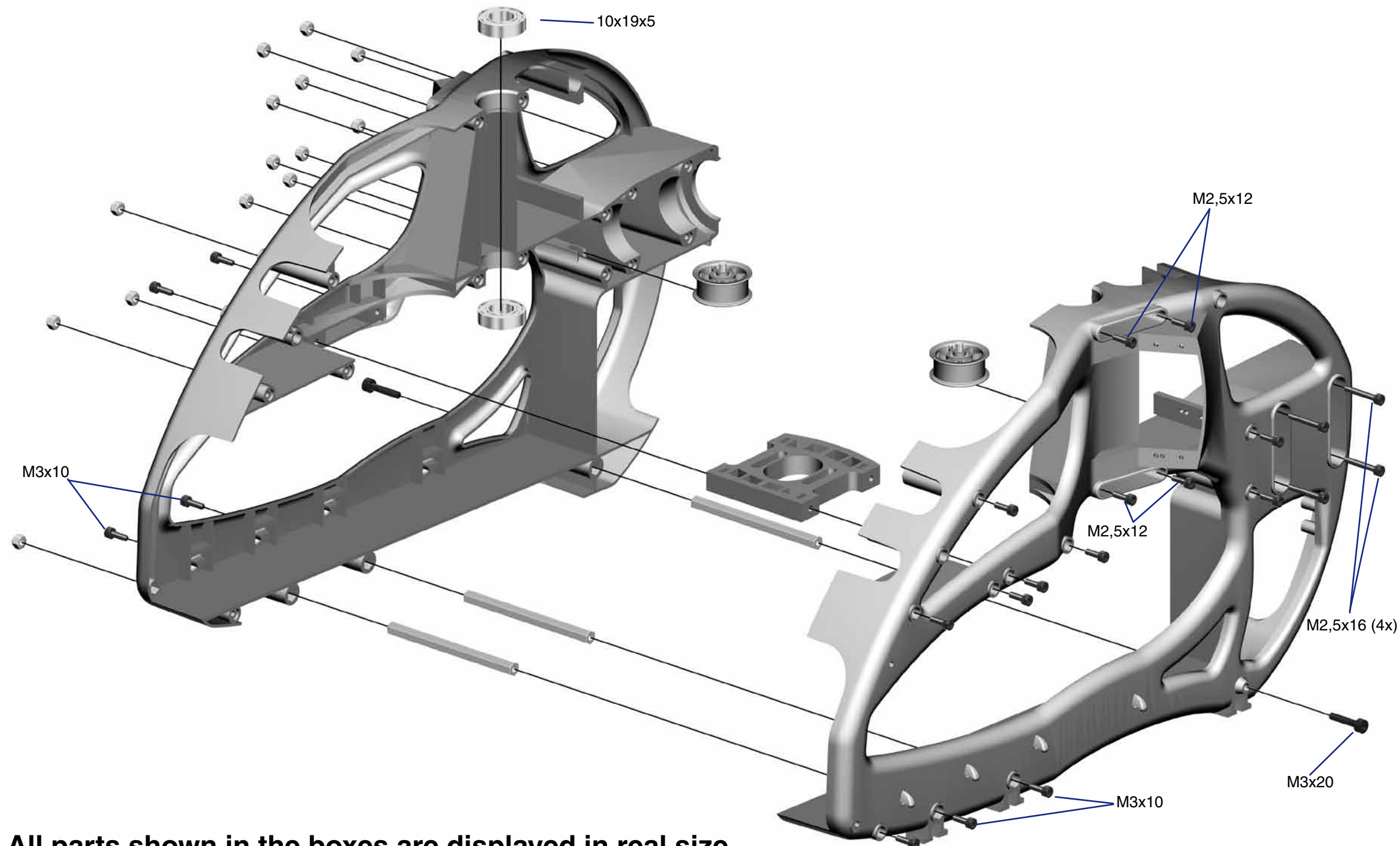
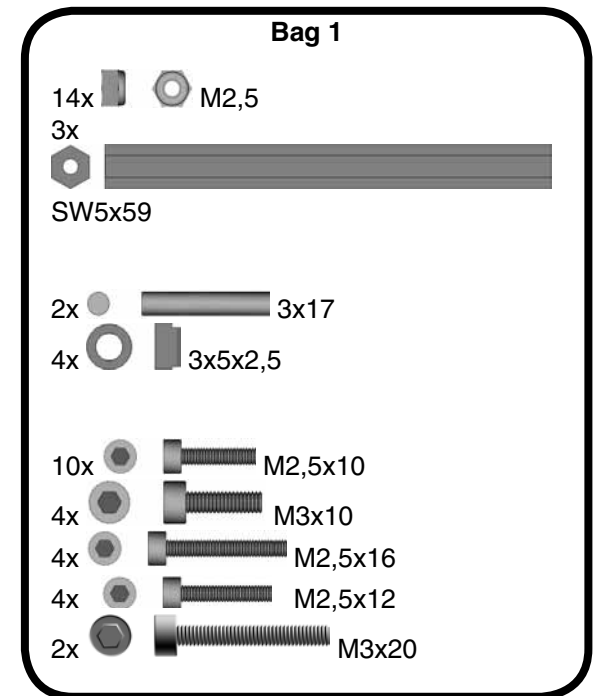

All parts shown in the boxes are displayed in real size.

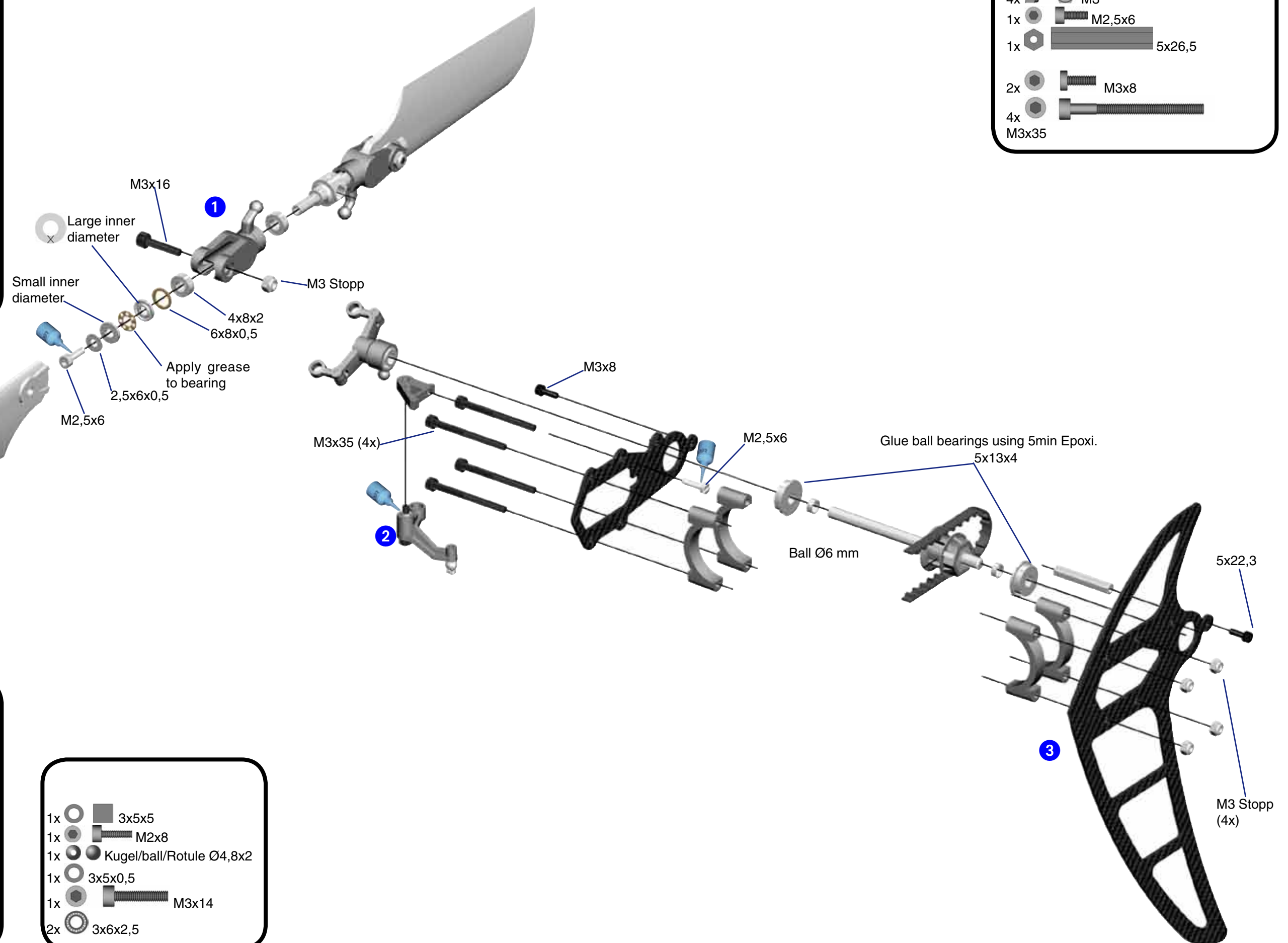
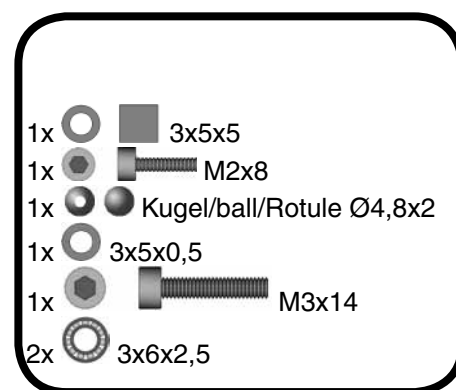
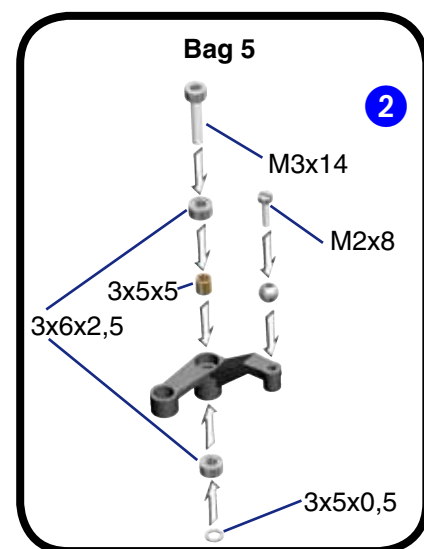
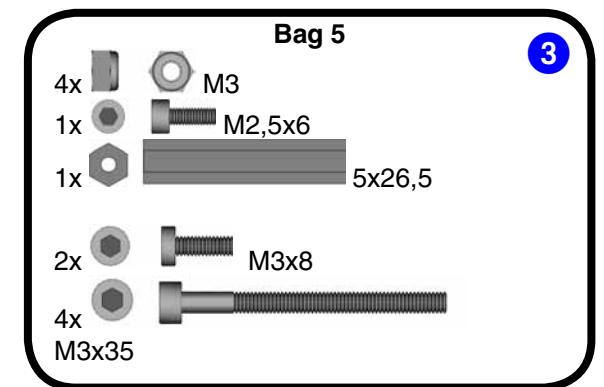
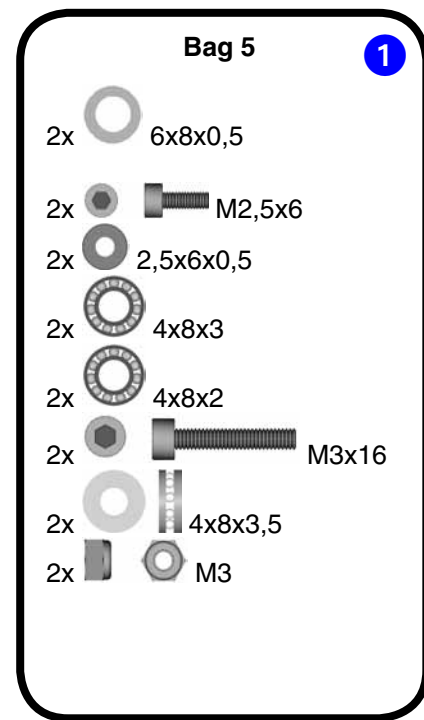

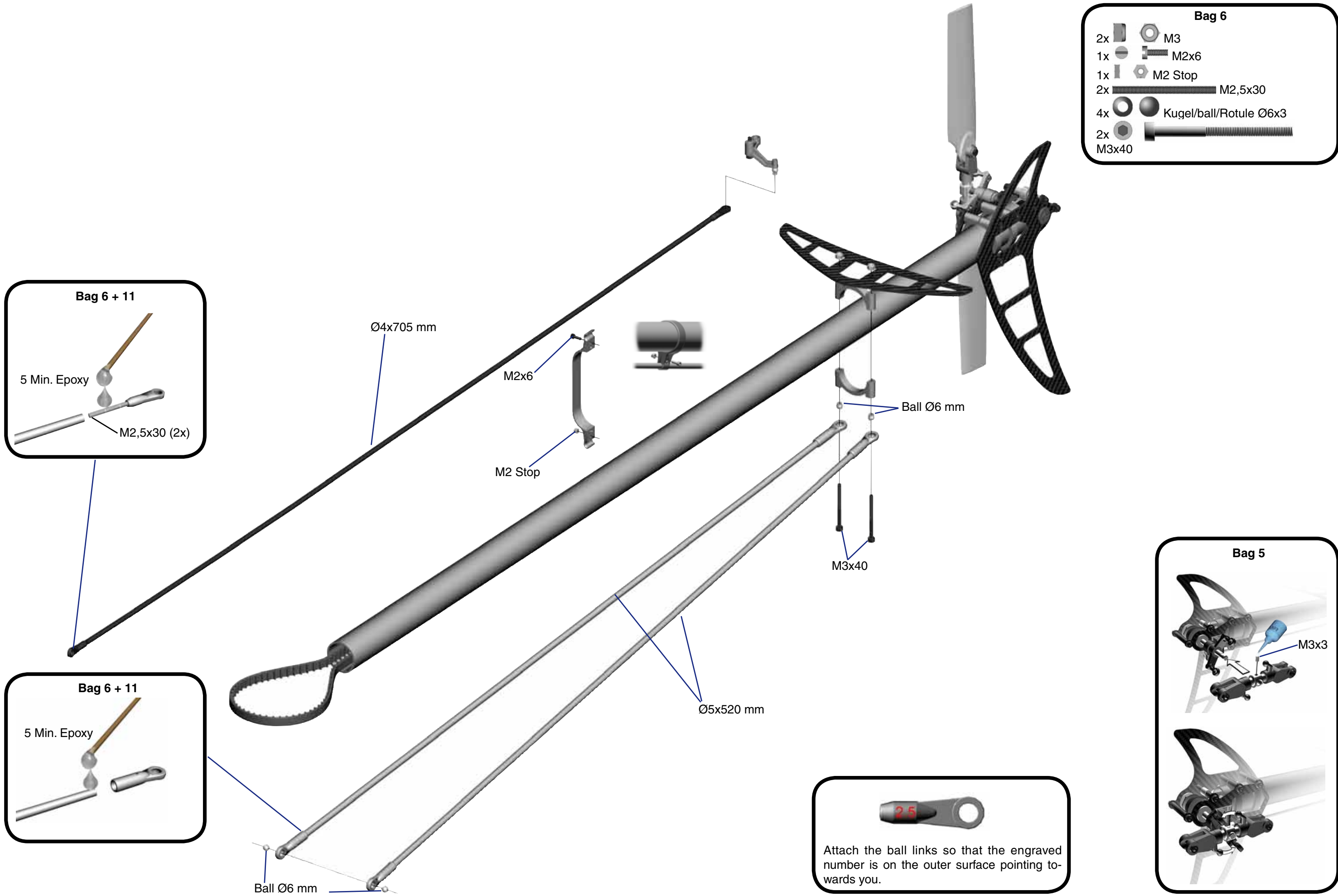

Bag 6

2x		M3
1x		M2x6
1x		M2 Stop
2x		M2,5x30
4x		Kugel/ball/Rotule $\varnothing 6 \times 3$
2x		M3x40

Bag 6 + 11

5 Min. Epoxy

M2,5x30 (2x)

Bag 6 + 11

5 Min. Epoxy

Bag 5

M3x3

Attach the ball links so that the engraved number is on the outer surface pointing towards you.

4 Main Gear & Tail Boom Assembly

Bag 2 • Bag 3 • Bag 6 • Bag 8

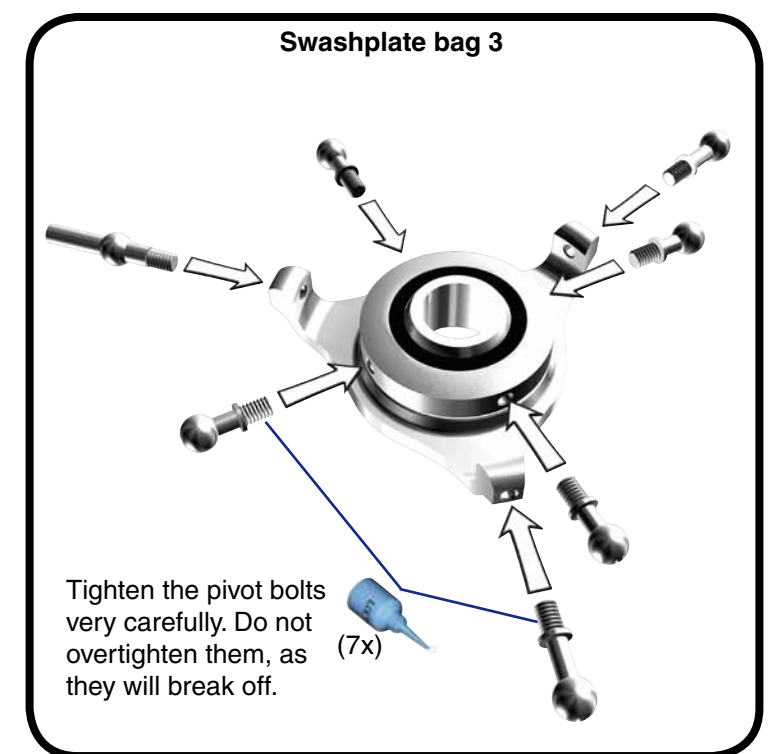
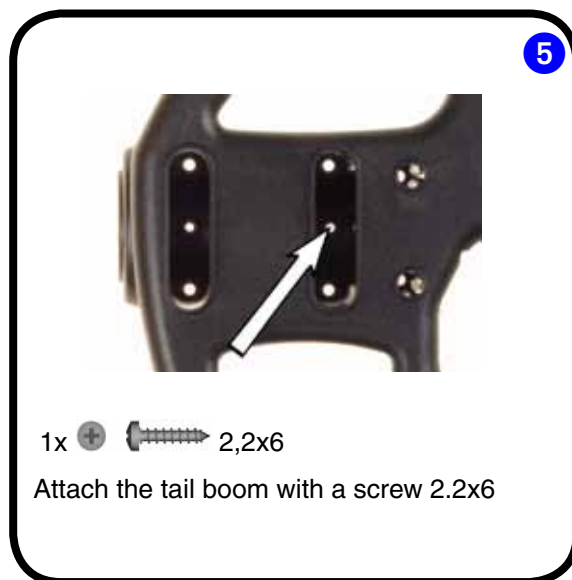
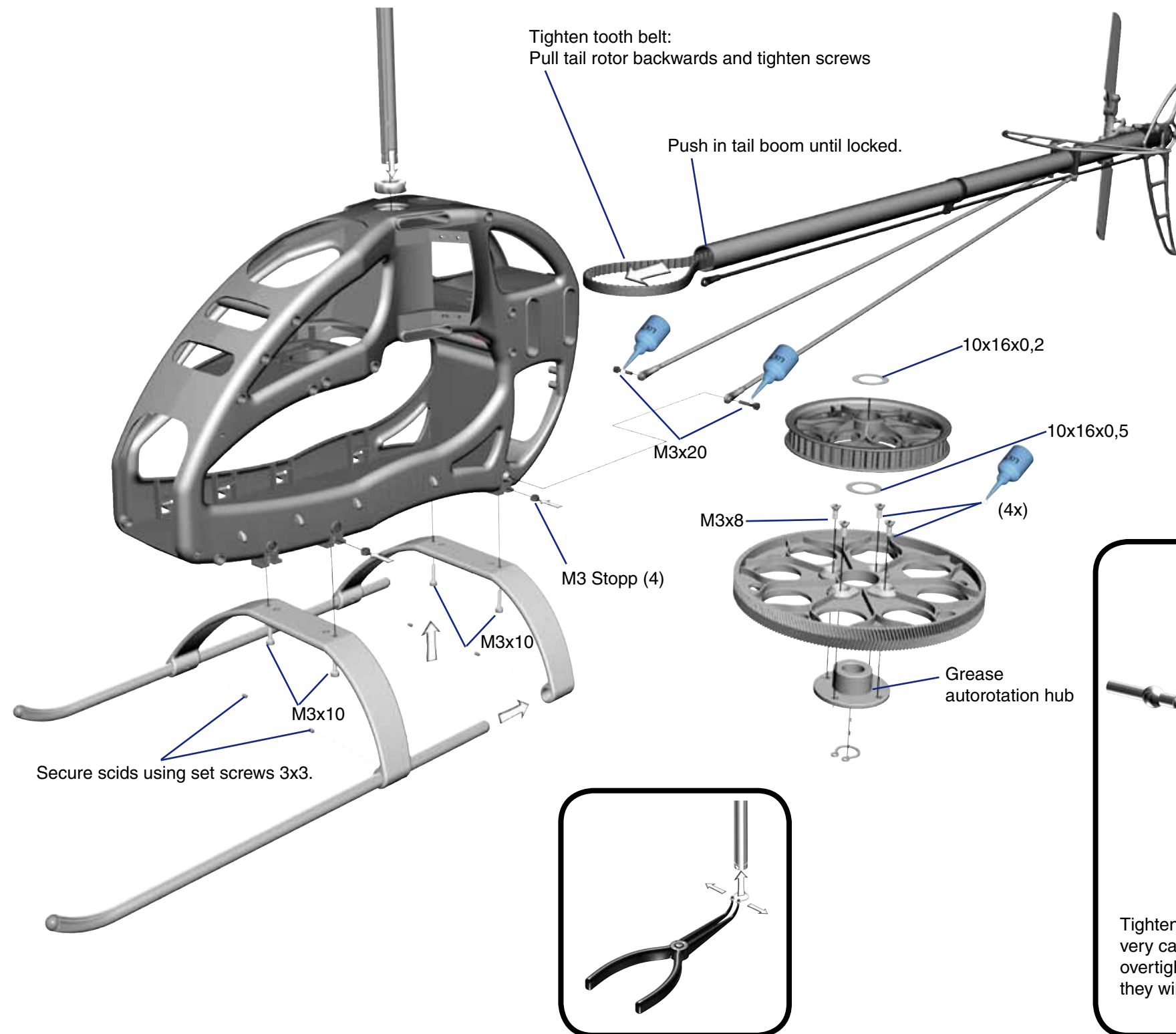
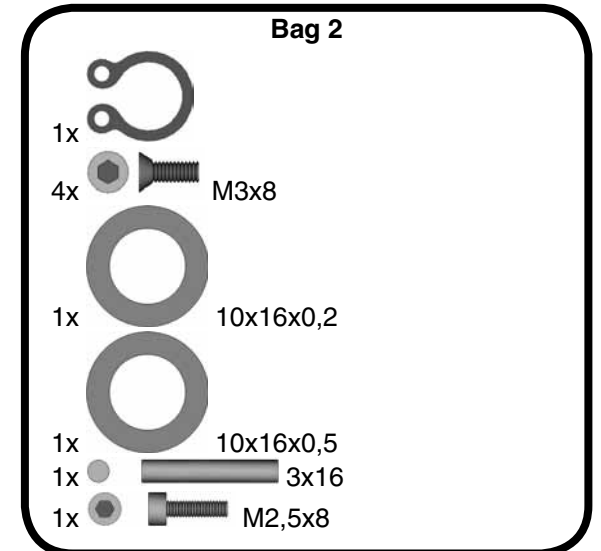
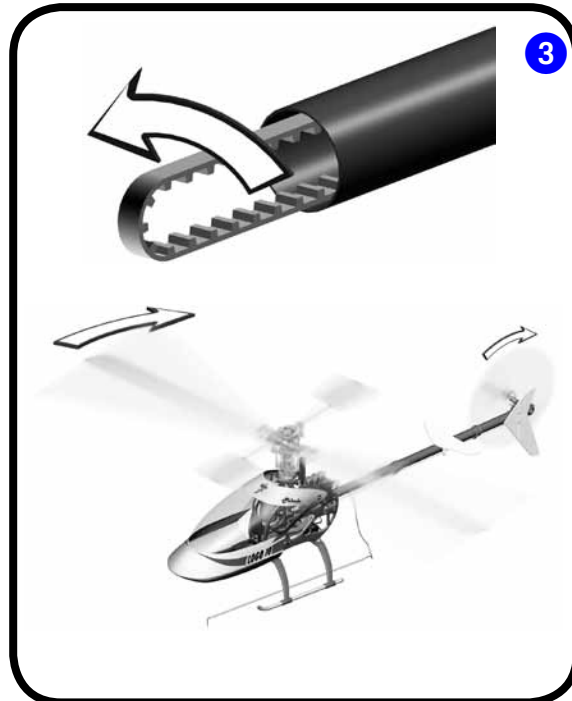
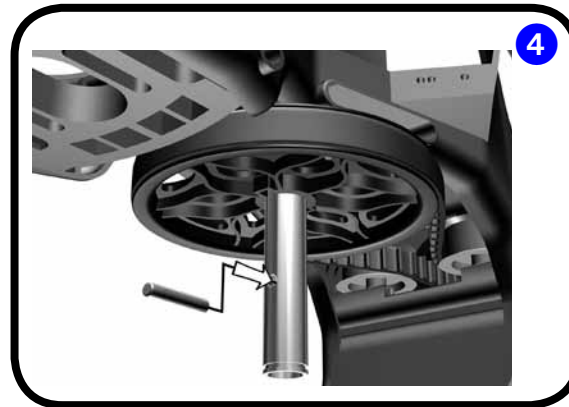
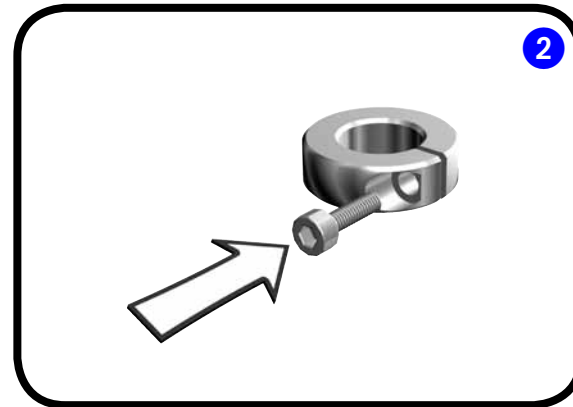
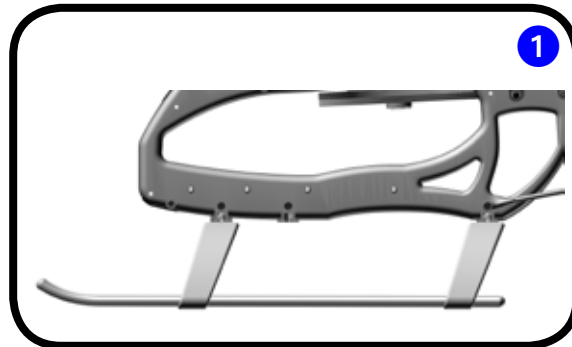

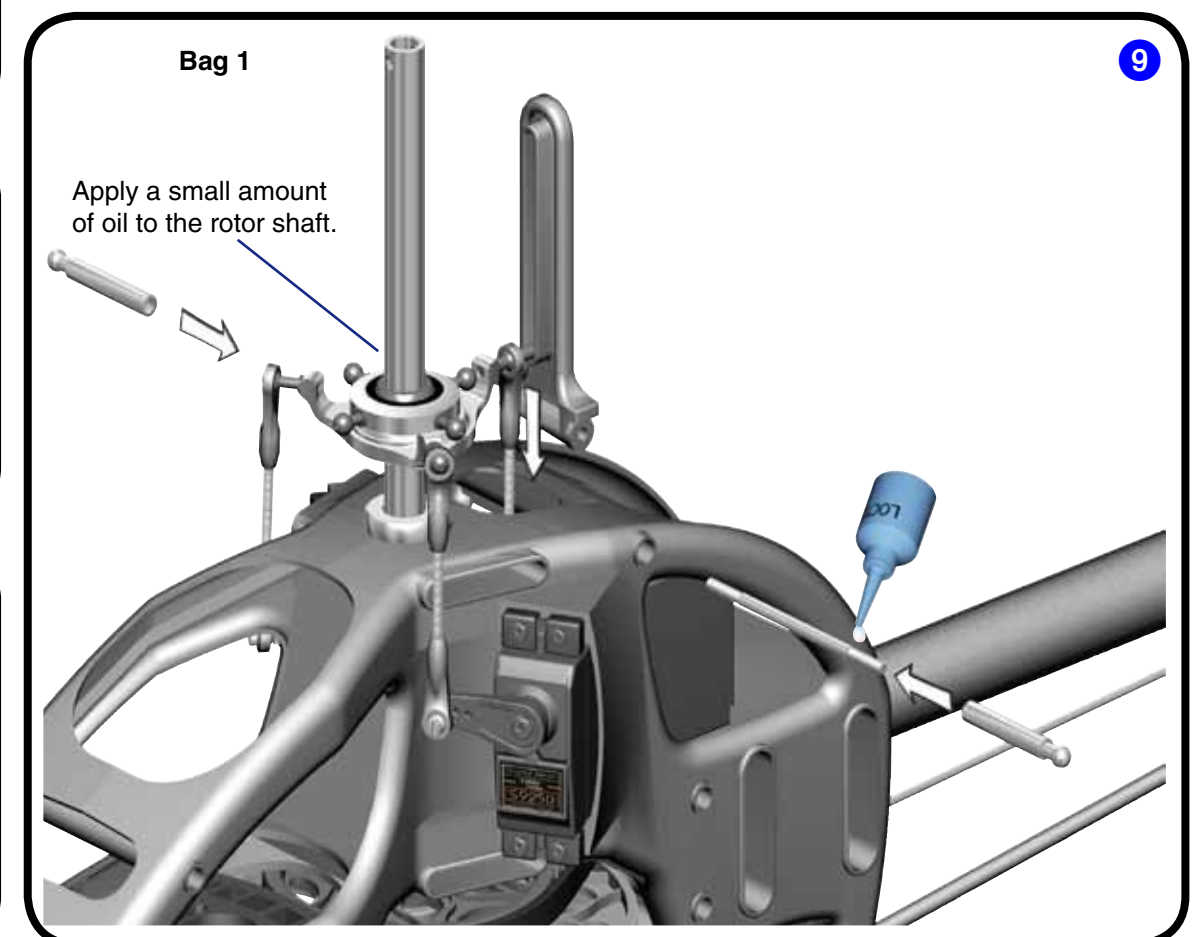
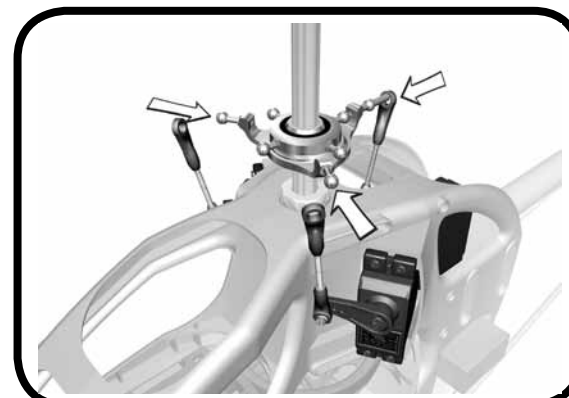
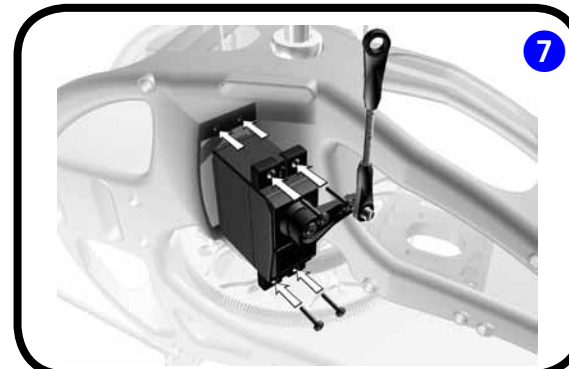
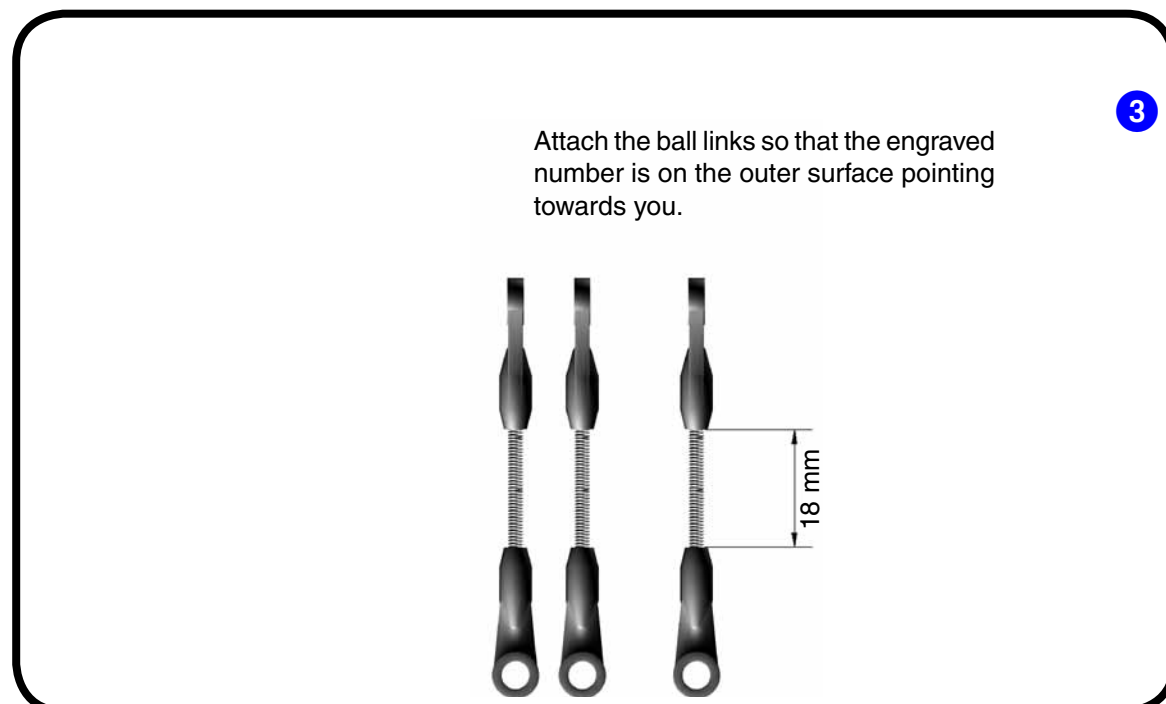
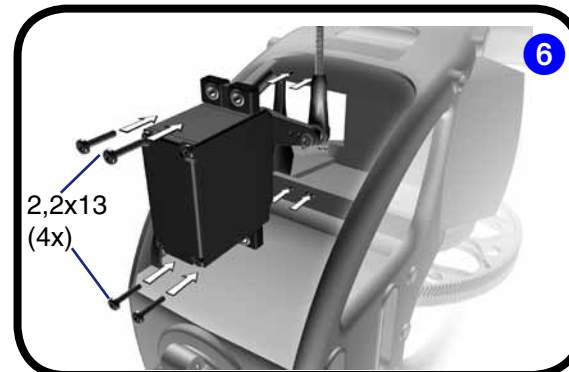
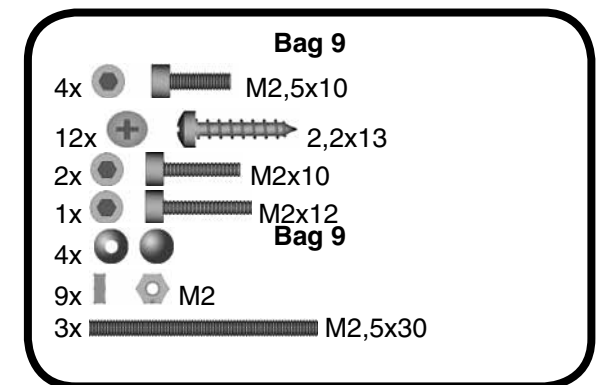
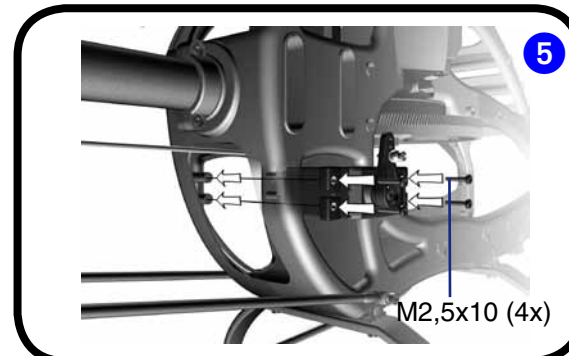
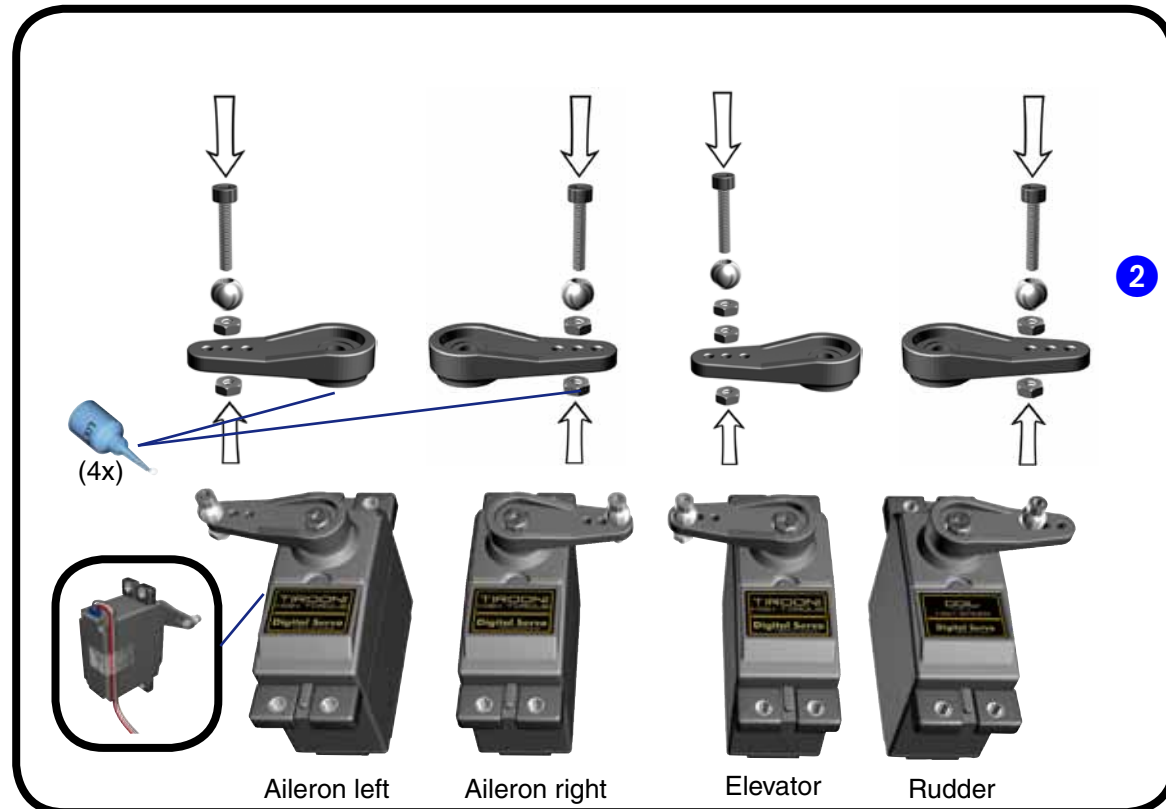
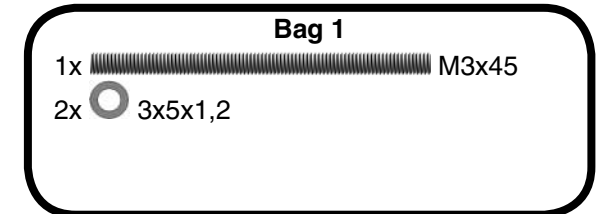
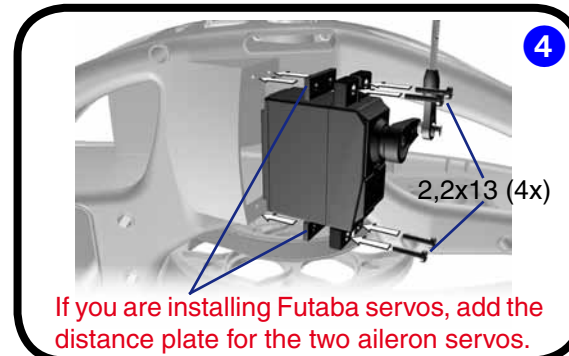
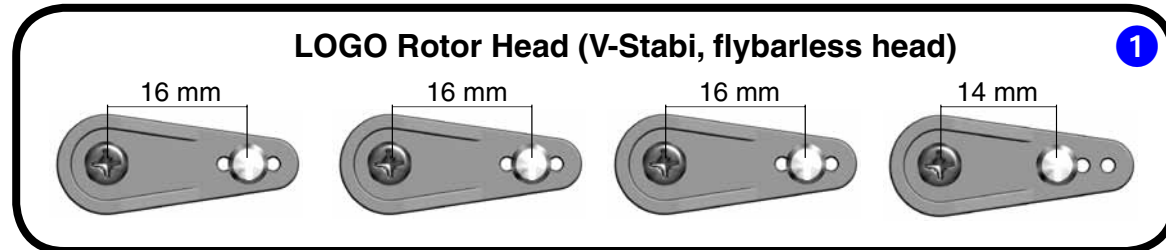

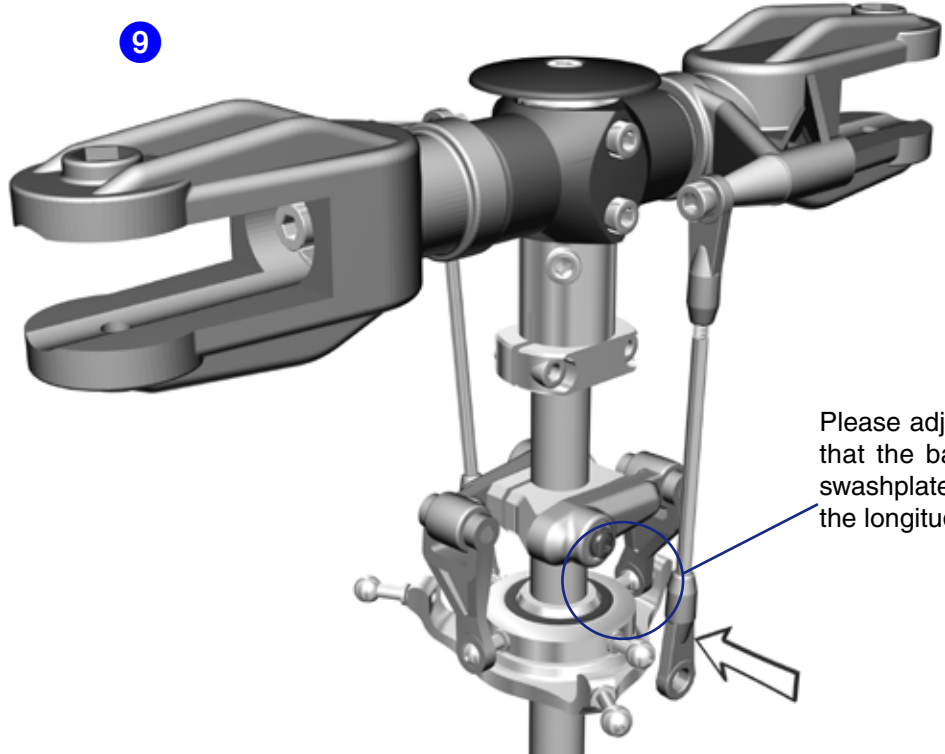
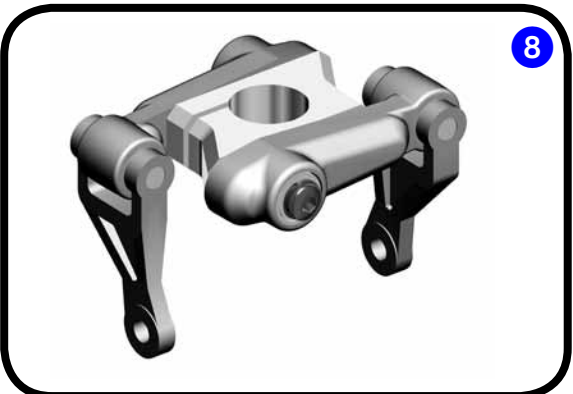
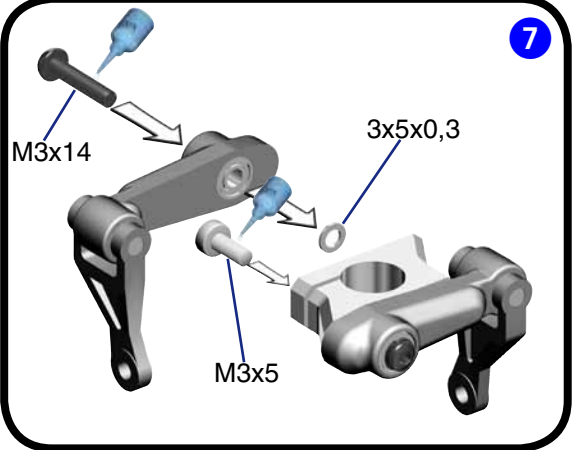
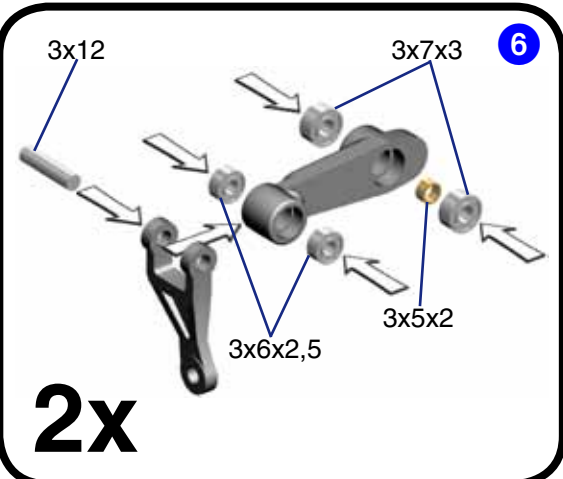
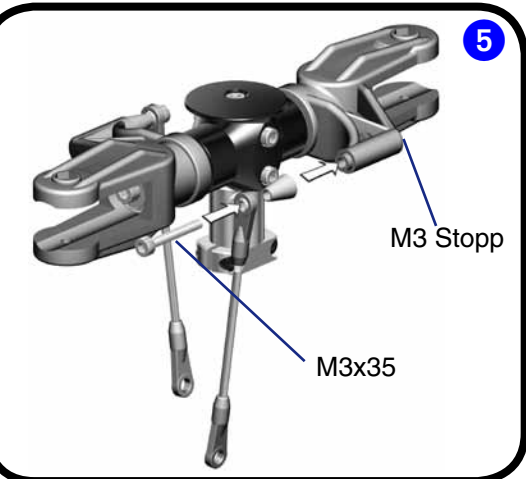
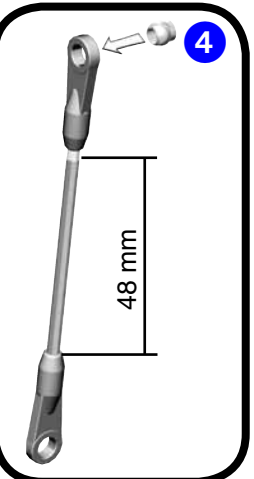
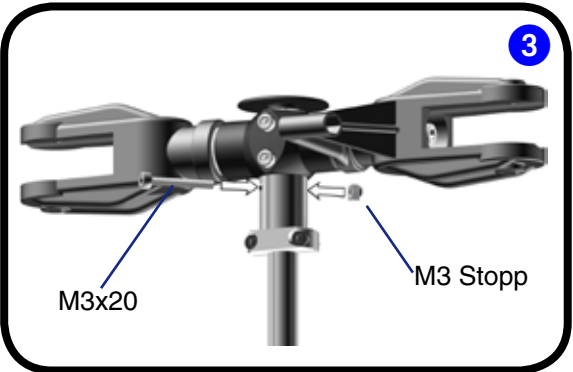
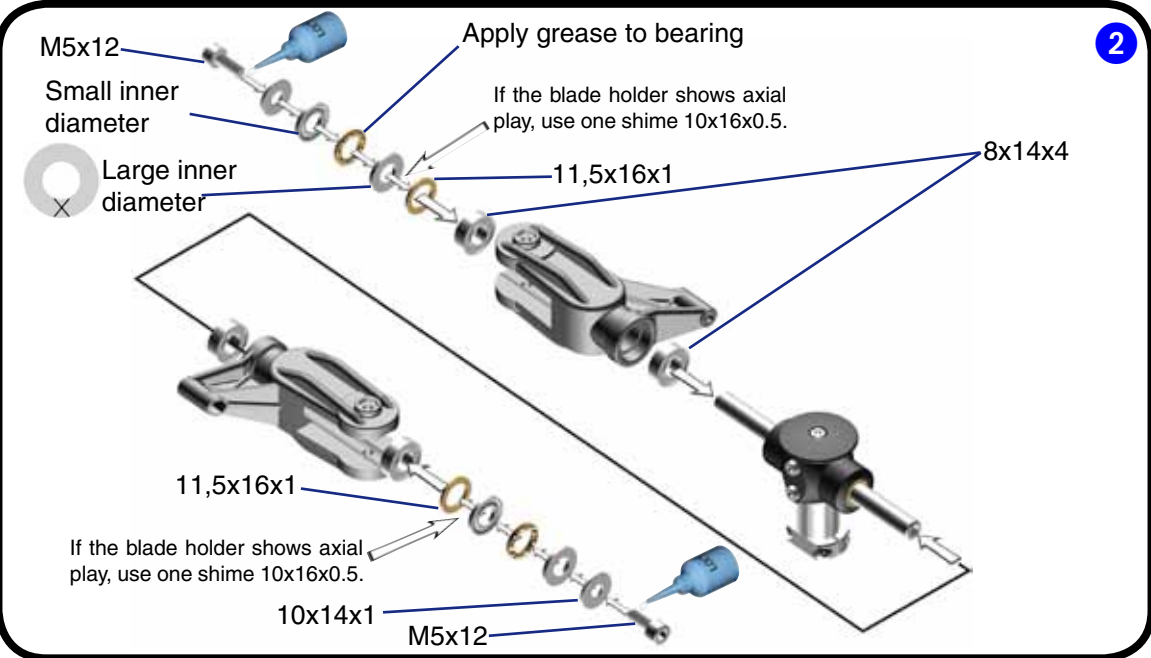
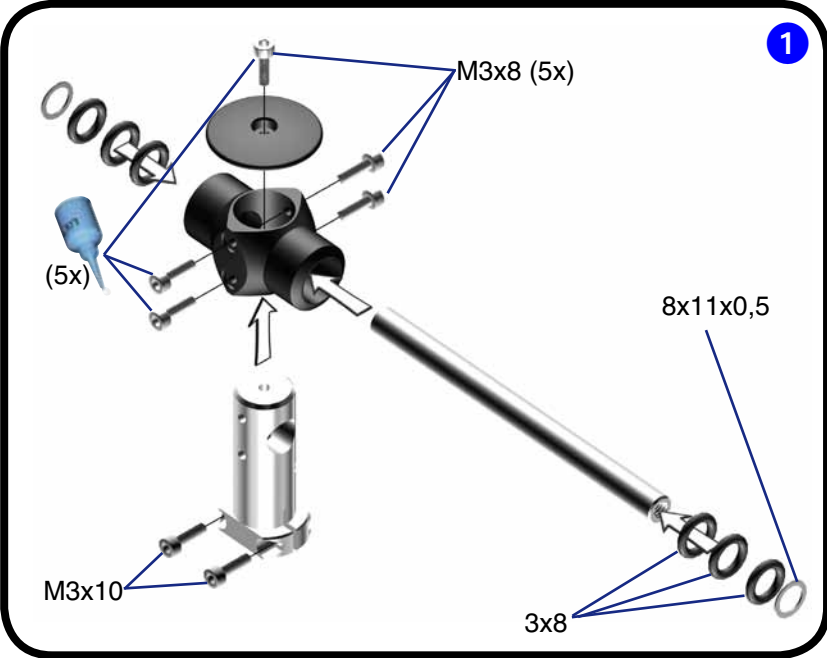

Please adjust the swashplate driver in such a way that the balls on the inner and outer ring of the swashplate are positioned exactly on a line along the longitudinal axis of the heli.

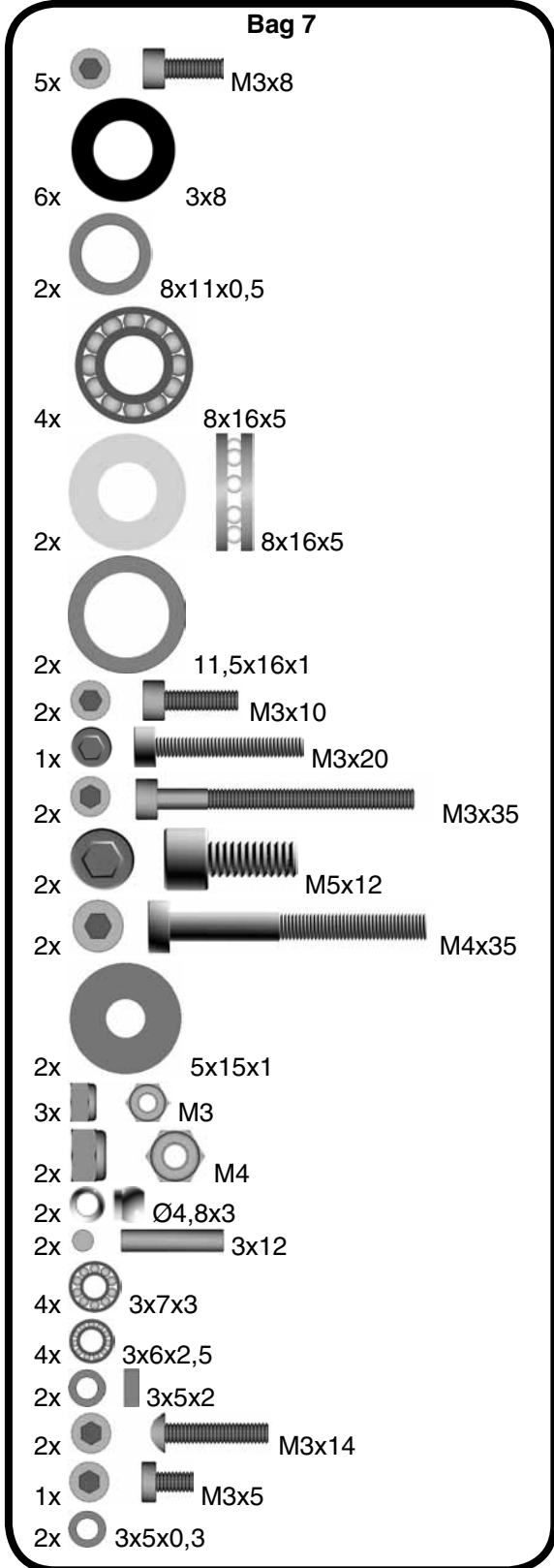

7 Mounting the Motor

Bag 1

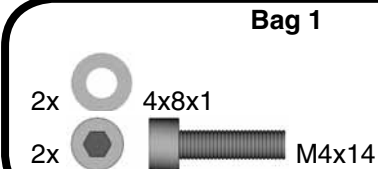

Installation of the Motor Pinion

Screw the motor pinion onto the motor shaft, making sure that it can still be moved. Now mount the motor on the motor plate and move the pinion so it is aligned well with the main gear. As visual help for aligning the pinion you may use the small ridge which separates the two parts of the pinion. When the pinion is aligned correctly it will easily engage with the main gear. If the pinion does not engage with the main gear, it is not correctly aligned. After the pinion is correctly aligned, take the motor out of the mainframe and tighten the set screw.

Gear Backlash

Move the motor with the pinion until it is limited by the gear. Tighten one of the M4x14 screws slightly. You must still be able to swivel the motor around its own axis. In this way you can easily determine the correct distance between the main gear and the pinion. There should be no (!) gear backlash. At the same time, the motor should not (!) exert any pressure onto the running surface of the main gear. After you have determined the correct distance, tighten the second M4x14 screw.

For very hard 3d flying counterbearing no. #4373 (30 mm, 6 mm shaft) should be installed.



available pinions for module 1 diameter 6 mm (not included in kit)

10 teeth*	#4410
11 teeth	#4411
12 teeth	#4412
13 teeth	#4413
14 teeth	#4414
15 teeth	#4415

*diameter 5 mm

8 Mounting the Canopy

Bag 1



Bag 1

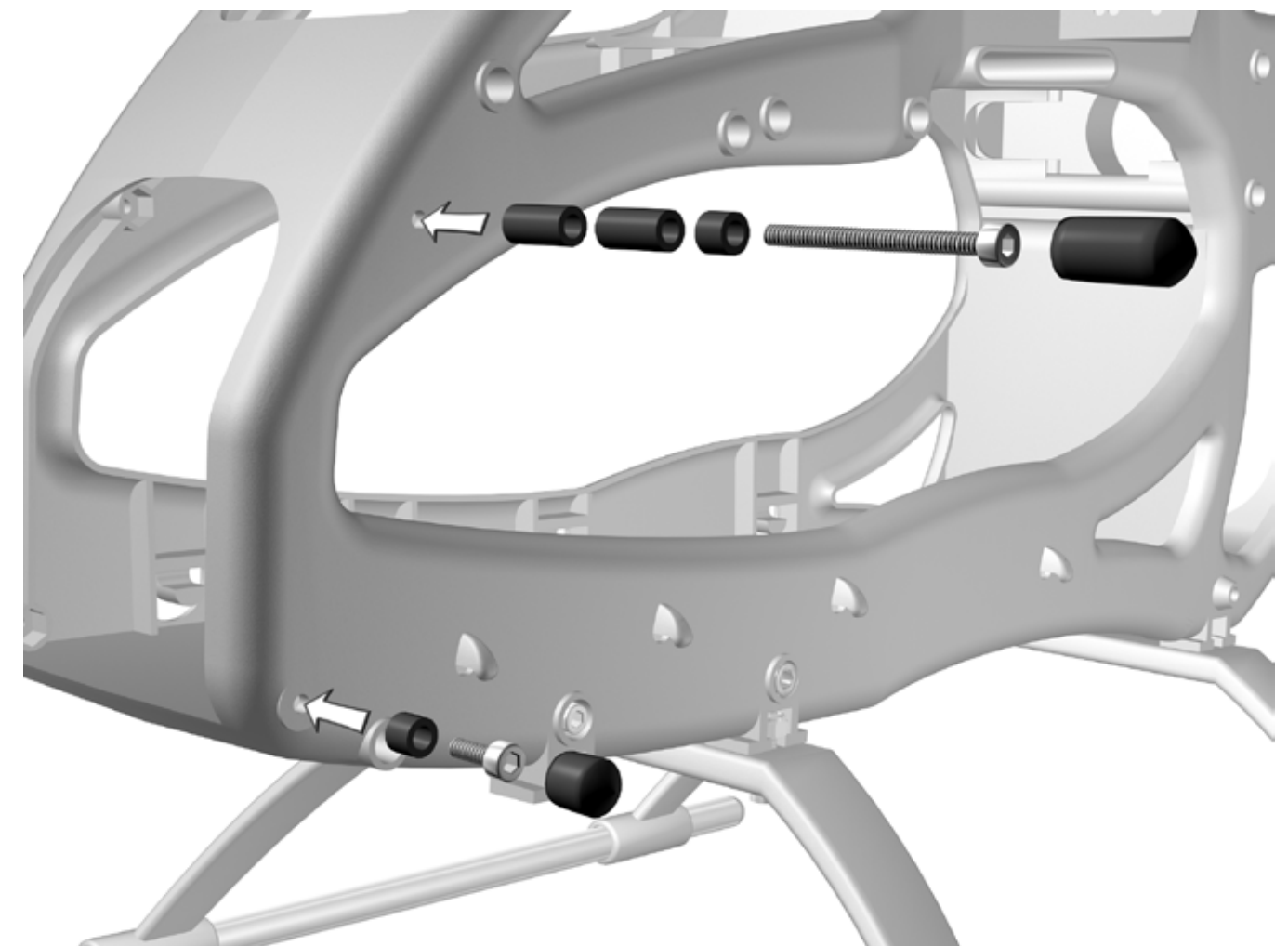

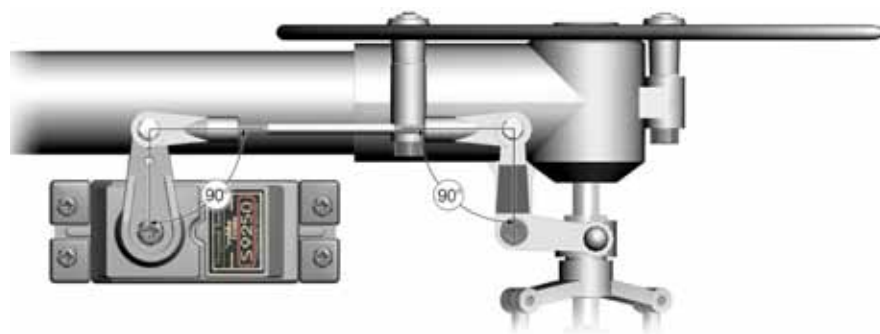

Position of servo arms for the tail rotor when sticks are centered



Position for mounting V-Bar gyro



Position of servo arms for the aileron servos when sticks are centered (0 deg. Pitch)

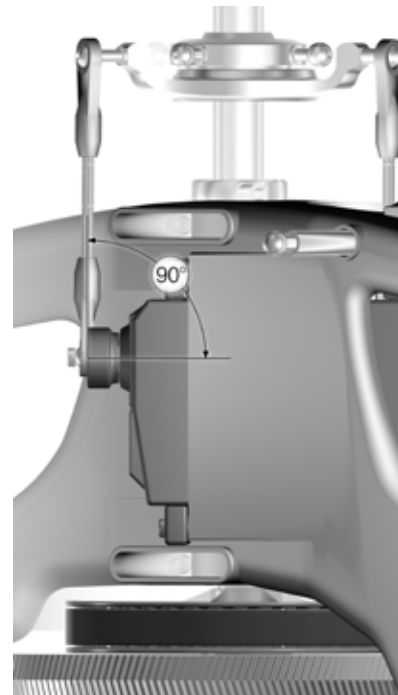

Receiver

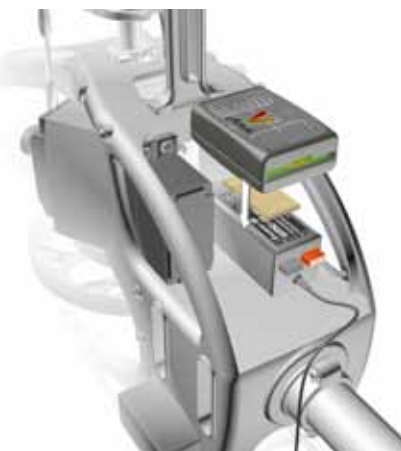

V-Bar Main board

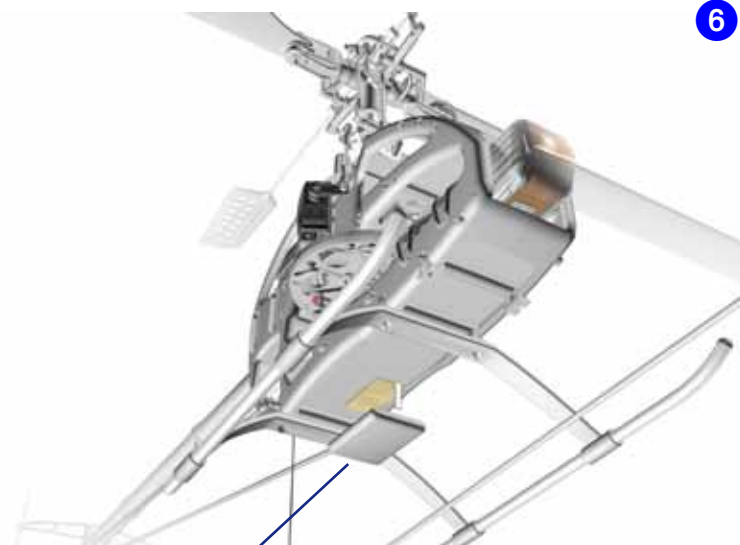

Position of LiPo battery for the power supply of receiver.

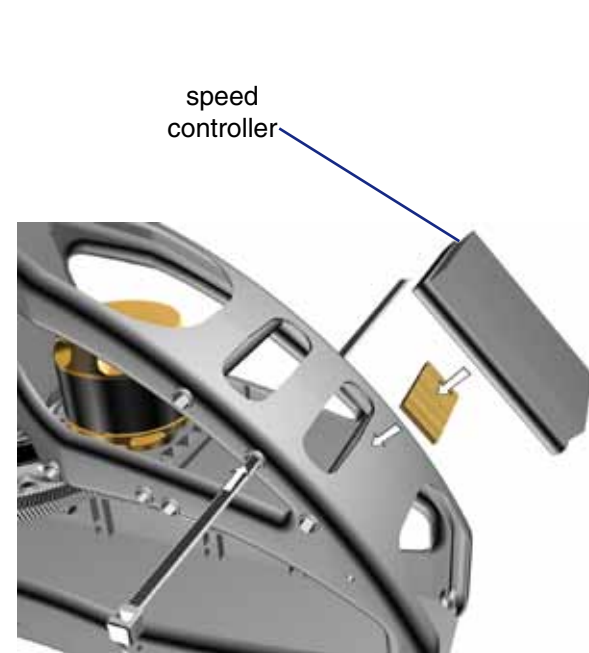

speed controller

Battery:
Attach the battery with the 3
Velcros.

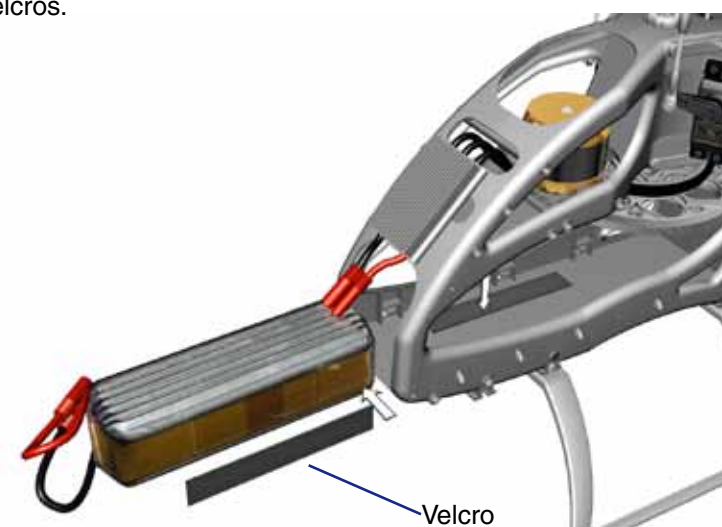

Velcro

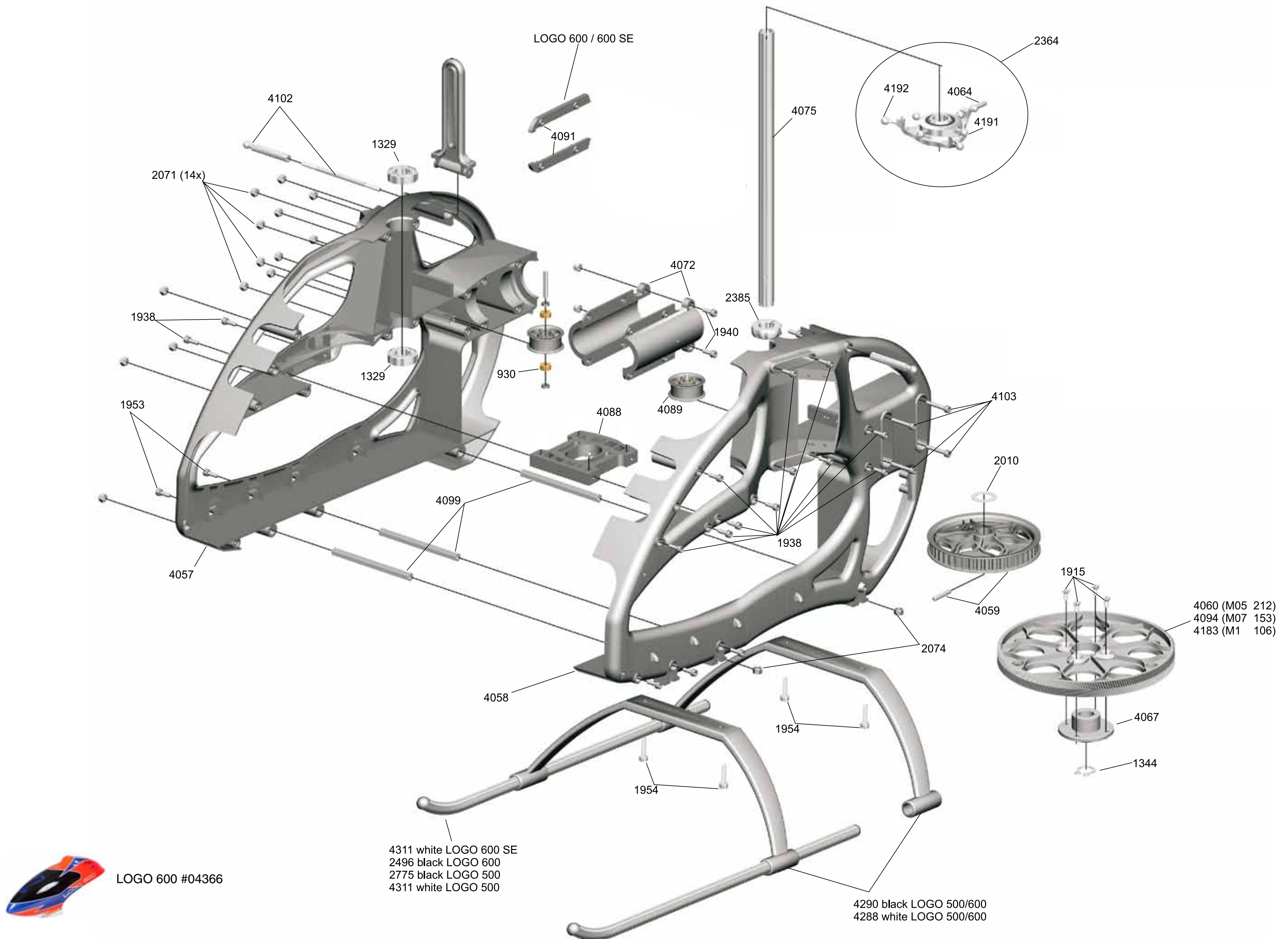

11 Overview Tail Rotor

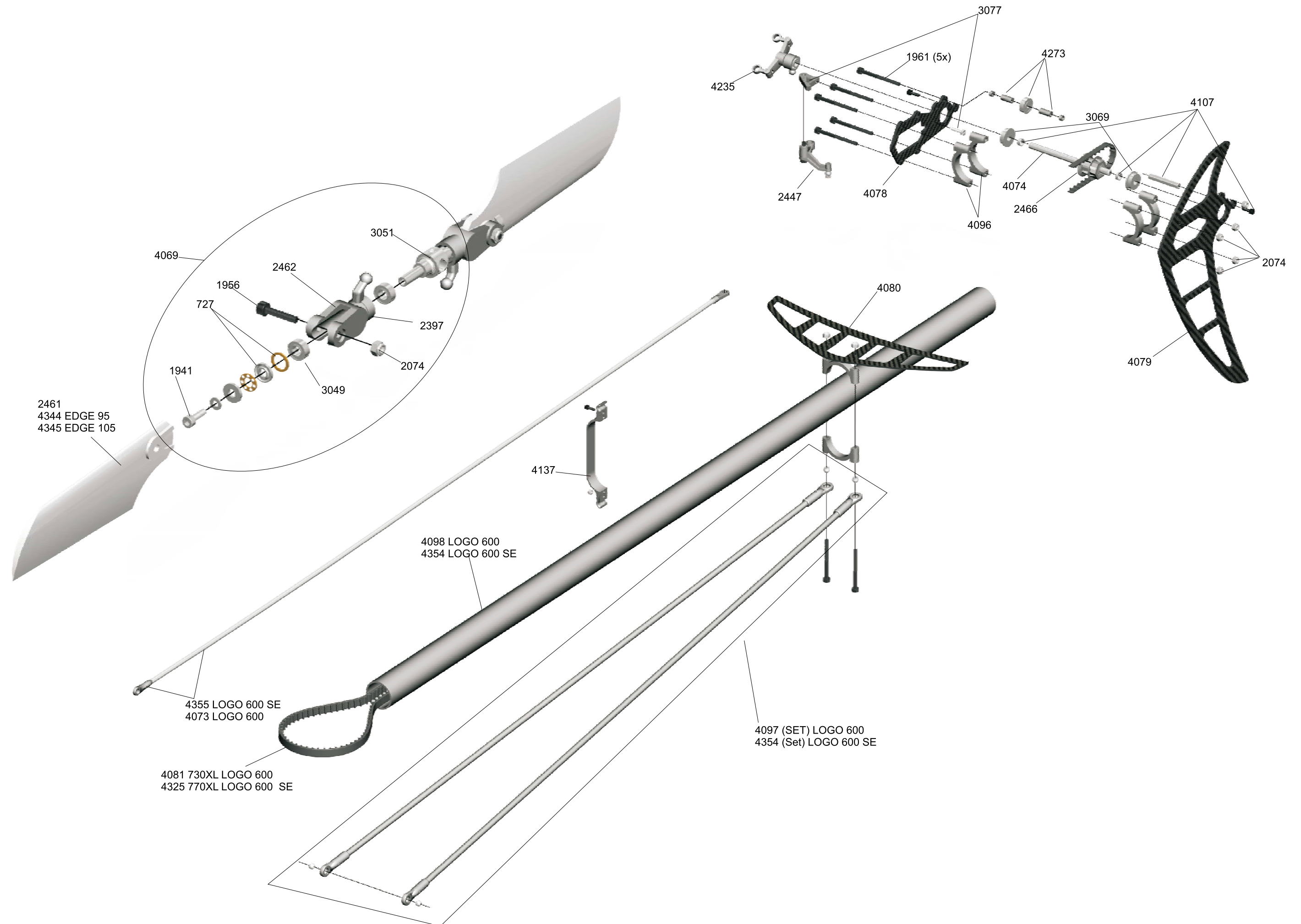

12 Overview V-Bar Head

